

// KAMP KLEPTO // AMERICAN DREAM // PROJECT DESCRIPTION //





// THE HISTORY OF KLEPTO //

The original Kamp Klepto was conceived on the playa during the Floating World, at Bowsprit & 105°. Five guys, some tarp, two turntables, three sticks of wood, a generator and a shit-load of vodka. As we started to build, other camps, in the spirit of the gift economy, started to donate whatever they could, some rope light here, a gazebo there, and voila, Kamp Klepto was born.

With Burning Man 2003 — Beyond Belief — Klepto became Kleptosis — joining the original Klepto ingenuity with an Oasis charm with palm trees to create a mirage, a vision on the horizon, just out of reach, beyond belief. To our great pleasure

we found that our efforts from the year before awarded us with a large number of returning guests to our camp.

// KLEPTO — AMERICAN DREAM //

For this year we are going back to our roots — our Burning Man 2008 theme camp will remain under the name Kamp Klepto — your friendly neighborhood DJ Bar. Ideally situated one or two street up from the esplanade on one of the spokes, Klepto will once again shake down any and all passing by with irresistible soulful funky house tunes and playful spirits.

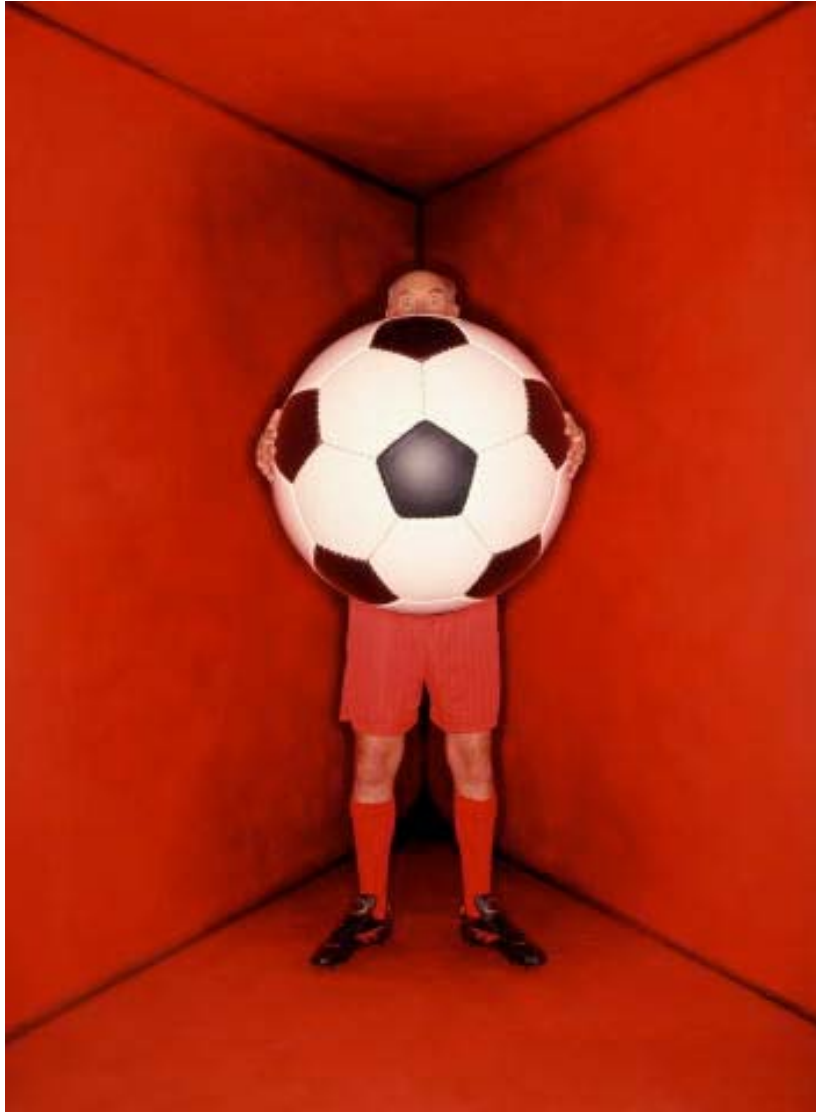

// KLEPTO — DAY THEME //

During the day Klepto will be a blissful oasis in the hot Black Rock City desert. Burners are free to wander in and out, chill, drink, relax, and maybe watch a movie. Make sure to check out the what, where, when for activation time-tables. We will have a plentiful supply of fresh coconuts, pineapples and other exotic fruits to replenish the body. DJs will be spinning a selection of down tempo chilled beats to satisfy the soul. There will be a prominence of Jamaican dub, reggae and dance hall style, interspersed with easy listening, blues and chill out.

- Hammocks & mattresses are available for lounging and chilling.
- DJs will play reggae, dub and lounge sessions during the day
- Dynamo Klepto United will organize yet another giant kickball event. The goal is, well there really is no goal, it's all about kicking a giant ball around.

EPTO — NIGHT THEME //

At night, Klepto is the Black Rock City equivalent of a DJ Lounge Bar. Drop by and have a cocktail (or two) and dance 'til you drop on our very own blend of happy house tunes. Burners may find themselves getting philosophical with one of our cigarette/candy girls, who will strip them bare naked of their thoughts. Just see it as a confessional, beware though, your confessions will be recorded and played back during the day.

- Fully loaded and stocked barter and gift (we do the gifting) bar.
- DJs playing happy house.
- Live bongo players who will interact with the DJ.
- Brightly illuminated dance-space, dance-floor illuminated with various lightening fixtures and mirror-balls.
- Cigarette & Candy for a thought girls, distributing cigarettes / candy. Spoken words will be recorded on tape and played back during the day.



// KLEPTO — SITE LAYOUT //

Our main structure will be a dome like shaped body covered by a 70 feet parachute. The parachute will provide shade during the day and will give a feeling of intimacy during the night, not to mention it can give protection during periods of rain, which we all hope will not happen. The structure will not be entirely closed of from top to bottom. We like the idea of an open structure where everybody can just wander in and out, plus the theme after all is under the vault of heaven. A DJ booth, Champaign Bar, lots of lighting and a couple of couches will be placed inside the actual dome. A separate canopy based structure will be erected to cover our mattress/lounge area. As usual Klepto will be surrounded by 3 to 5 illuminated palm trees. A large white sheet will be placed on one of the sides of the dome. This sheet will be used to project movies on. An illuminated Klepto sign will guide burners at night to our little Oasis in the desert.

Total camp footprint: 150 x 150 feet

2002 placement: NE corner of Bowsprit @ 105°

2003 placement: NW corner of Dogma & Received

2004 placement: Mercury & 3 o'clock Plaza

2005 placement: 3:30 & Amnesia

2006 placement: 3:00 O'Clock Plaza

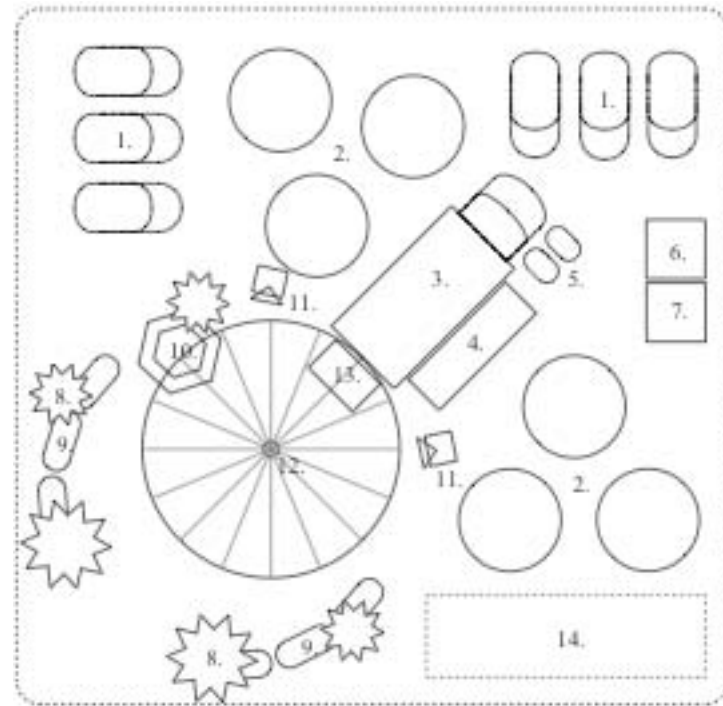

01. Car Parking
02. Tent Areas
03. Uhaul Truck, 26 feet
04. Cooking Area
05. Two Generators (Muffled)
06. Gray Water Disposal, 10x10 feet
07. Shower
08. Glowing Coconut Palm Trees
09. Couches/Mattresses
10. Bar
11. Speakers
12. Shade Structure (see separate illustration)
13. DJ Booth
14. Bicycle Parking

LEPTO —STRUCTURE //

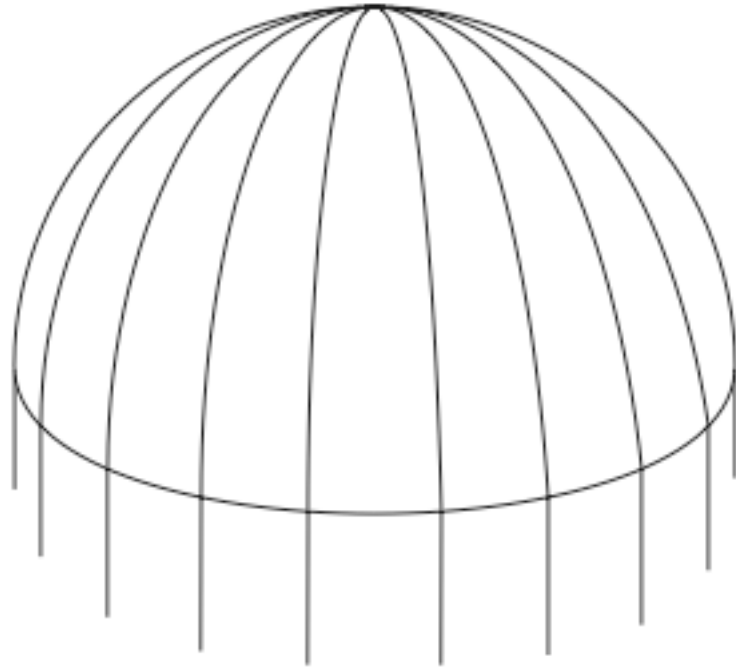

Made out of an old military issue cargo parachute. Anchored with a 300 pound concrete foot, elevated with one 24 feet x 10 inches PVC pipe and spread/shaped by threading eight 25 feet x 1 inch PVC pipes through the rope channels. Half way up the center pipe we place a rig for light fixtures. Caballing goes up inside the center pipe. According to our calculations this structure will be able to handle winds of up to 50 feet per second. If the wind goes above that we can (1) lower the light rig, or (2) fold the 'shute like a beach parasol.

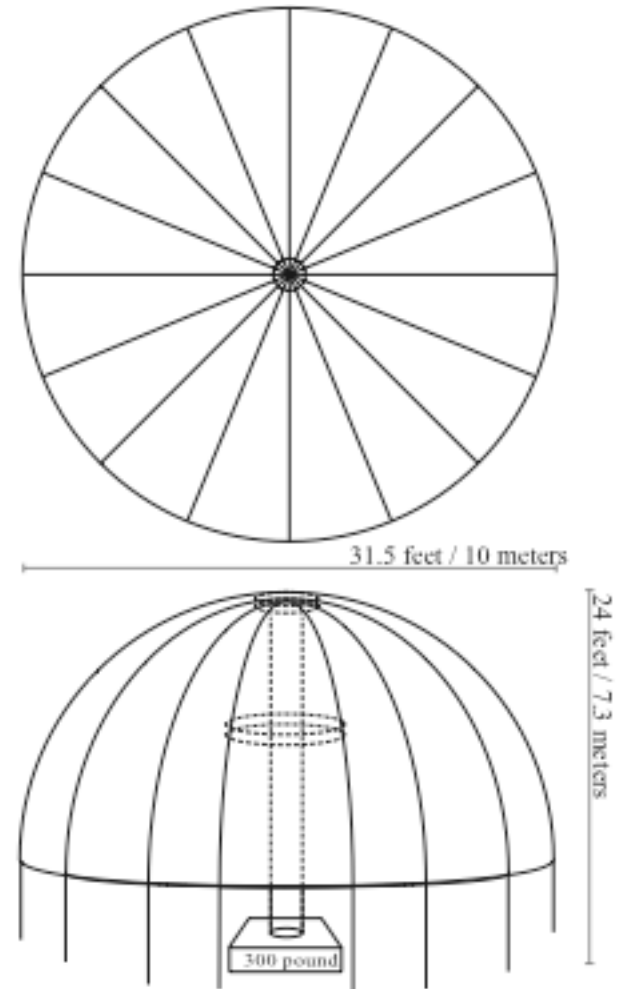

Circumference: 70 feet / 21 meters
Diameter: 44 feet / 14 meters
Height: 24 feet / 7.3 meters

// KLEPTO — CLEAN UP PLAN //

Our motto at Klepto regarding cleaning is simple:

“Do not leave a trace, leave an impression”

We are committed to leaving the playa cleaner than how we found it. In order to minimize the Sunday clean-up effort and trash rolling around on the playa we are taking the following measures:

- Shade structure: Recycle
- Champaign bar: Made out of wood, will burn
- DJ Booth: Recycle
- Illuminated Palm Trees: Recycle
- Illumination devices, burn parts of trees
- Couch: Recycle
- Mattresses: Recycle
- Wooden tables-tops: Burn
- Klepto sign: Recycle
- Non-shag carpet on area floor to prevent litter directly hitting the playa
- Four trashcans will be highly profiled.
- Ashtrays will be situated in the lounge area, bar area and wooden tables.
- After every night the Klepto crew and its guests will clean up the entire site.
- Gray water disposal.
- No cup, no drink policy

We will be bringing with us a manual compacting machine to minimize volume of waste we will need to remove from Black Rock. We will also be dividing the waste in recycleable materials.





// KLEPTO — TIME TABLE //

Stay tuned or read the what, where and when for a detailed list of all our activities. Most pick-up soccer games will be played around dusk, wireless access will be provided in the afternoon and as always, our parties start late and end later...

// KLEPTO — TEAM //

The core Klepto team is 10 strong. In addition to this we normally have some 15-20 tag-alongs that join our camp between here and BRC.

Klepto main contact:

Jake Hofwegen
ghofwegen@hotmail.com